

MODEL	CODE	φD (CLAMPING RANGE)	L		L1		φC	N/W (kg)	
			OPEN	CLOSE	OPEN	CLOSE			
SK40	-SDC08-088	77090	0.5~8	87.5	95	50	57.5	37.5	1.3
	-SDC13-105	77095	1~13	103.5	116	66	78.5	50	1.8
SK50	-SDC08-087	77320	0.5~8	87.5	95	50	57.5	37.5	4.1
	-SDC13-110	77325	1~13	103.5	116	66	78.5	50	4.5
BT30	-SDC13-160	77326	1~13	153.5	166	66	78.5	50	5.1
	-SDC08-080	10036	0.5~8	83	90.5	50	57.5	37.5	0.7
BT40	-SDC13-100	10038	1~13	99	111.5	66	78.5	50	1.3
	-SDC08-080	11148	0.5~8	83	90.5	50	57.5	37.5	1.3
BT50	-SDC13-100	11150	1~13	99	111.5	66	78.5	50	1.8
	-SDC08-100	13291	0.5~8	103	110.5	50	57.5	37.5	4.1
BT50	-SDC13-160	13293	1~13	119	131.5	66	78.5	50	4.5
	-SDC13-120	13294	1~13	159	171.5	66	78.5	50	5.1

ORDERING EXAMPLE

① **BT30** - ② **SDC** - ③ **08** - ④ **080**

- ① Shank Size
- ② Holder's Name
- ③ Max. φD
- ④ Gauge length



< HSK SHANK > COOLANT PIPE

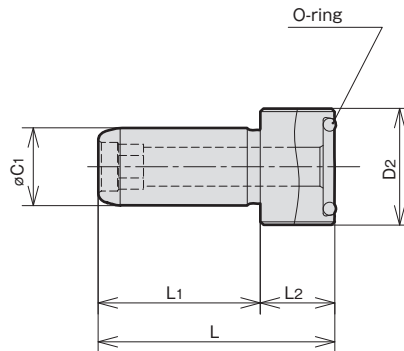

MODEL	CODE	HSK No.	D1	D2	L	L1	L2	O-ring
CLP-032	25180	HSK32	6	M10×1.0	26	20.5	5.5	P4
CLP-040	25181	HSK40	8	M12×1.0	29.5	22	7.5	P6
CLP-050	25182	HSK50	10	M16×1.0	33	23.5	9.5	P9
CLP-063	25183	HSK63	12	M18×1.0	36.5	25	11.5	P11
CLP-080	25184	HSK80	14	M20×1.5	40	26.5	13.5	P12
CLP-100	25185	HSK100	16	M24×1.5	44	28.5	15.5	P15

ORDERING EXAMPLE

① **CLP** - ② **032**

- ① Name
- ② HSK No.