

## FEATURES

- Versatile modular type boring system.
- Rigidity is increased by the new coupling method and the serrated head.
- Twin blades allow heavy cutting.
- Extensions are used for deep holes.

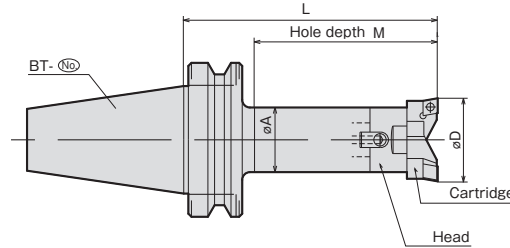

RANGE	MODEL	CODE	SHANK	HEAD	CARTRIDGE	INSERT	L	M	φA	N/W (kg)	
φ25~33	- TWC 25 - 120 - S	11710	BT40	- SBS1 - 120	HE25	CT25	120	85	24	1.3	
φ32~45	- TWC 32 - 135 - S	11720		- SBS2 - 130	HE32	CT32		135	100	31	1.6
φ44~63	- TWC 44 - 135 - S	11730		- SBS3 - 135	HE44	CT44	100		42	2.0	
φ62~89	- TWC 62 - 135 - S	11740		- SBS4 - 135	HE62	CT62			165	54	2.7
φ88~126	- TWC 88 - 165 - S	11750		- SBS5 - 165	HE88	CT88	WT25-079	130		64	4.4
φ25~33	- TWC 25 - 150 - S	14010	BT50	- SBS1 - 150	HE25	CT25	150	104	24	4.0	
φ32~45	- TWC 32 - 165 - S	14020		- SBS2 - 165	HE32	CT32		165	119	31	4.2
φ44~63	- TWC 44 - 165 - S	14030		- SBS3 - 165	HE44	CT44	WT32-095		119	42	4.7
	- TWC 44 - 225 - S	14031		- SBS3 - 225					225		179
φ62~89	- TWC 62 - 165 - S	14040		- SBS4 - 165	HE62	CT62	WT62-127	165	119	5.5	
	- TWC 62 - 240 - S	14041		- SBS4 - 240				240	194	54	6.7
	- TWC 62 - 285 - S	14042		- SBS4 - 285				285	239	7.4	
φ88~126	- TWC 88 - 165 - S	14050		- SBS5 - 165	HE88	CT88	WT62-127	165	119	6.7	
	- TWC 88 - 240 - S	14051		- SBS5 - 240				240	194	64	8.4
	- TWC 88 - 330 - S	14052		- SBS5 - 330				330	284	10.4	
φ125~175	- TWC125 - 165 - S	14060	- SBS6 - 165	HE125	CT125	WT62-127	165	119	7.7		
	- TWC125 - 240 - S	14061	- SBS6 - 240				240	194	82	10.6	
	- TWC125 - 330 - S	14062	- SBS6 - 330				330	284	14.2		

NOTE : 1. Inserts are sold separately.  
 2. Inserts are in phase with the drive key.  
 3. Thru-the-tool coolant type is manufactured to orders.

## ORDERING EXAMPLE

①	BT40	②	TWC	③	25	④	120	⑤	S
①	Shank Size								
②	Name								
③	Min. φD								
④	G.L. Length								
⑤	Set								

ACCESSORIES  
 P.70 INSERTS

ACCESSORIES  
 P.74 EXTENSION · REDUCTION

# <BORING SYSTEM> TWINCUT for LARGE BORE BT50<sup>(No.)</sup>-TWC<sup>(D)</sup>MIN-L-S

## FEATURES

For high stock removal with balanced blade, for  $\phi 175 \sim \phi 375$ mm bores.

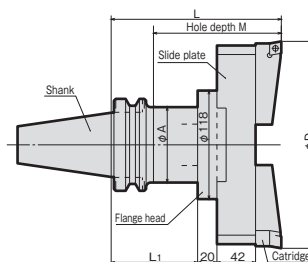

RANGE(D)	MODEL	CODE	SHANK	FLANGE HEAD	SLIDE PLATE	CARTRIDGE	INSERT	L	M	øA	N/W (kg)
ø175~225	- TWC175 - 185 - S	14070	BT50	TWC - FH - 0 (TWC - FH - 90)	SP175 - 42	CT125	WT62-127	185	139	82	12.8
	- TWC175 - 260 - S	14071						260	214		15.8
	- TWC175 - 350 - S	14072						350	304		19.3
ø225~275	- TWC225 - 185 - S	14073	BT50	TWC - FH - 0 (TWC - FH - 90)	SP225 - 42	CT125	WT62-127	185	139	82	14.3
	- TWC225 - 260 - S	14074						260	214		17.2
	- TWC225 - 350 - S	14075						350	304		20.7
ø275~325	- TWC275 - 185 - S	14076	BT50	TWC - FH - 0 (TWC - FH - 90)	SP275 - 42	CT125	WT62-127	185	139	82	16.7
	- TWC275 - 260 - S	14077						260	214		19.7
	- TWC275 - 350 - S	14078						350	304		23.2
ø325~375	- TWC325 - 185 - S	14079	BT50	TWC - FH - 0 (TWC - FH - 90)	SP325 - 42	CT125	WT62-127	185	139	82	17.9
	- TWC325 - 260 - S	14080						260	214		20.9
	- TWC325 - 350 - S	14081						350	304		24.4

- NOTE : 1. Inserts are sold separately.  
 2. Inserts are in phase with the drive key.  
 3. TWC-FH-90 Flange Head is used to change the phase to 90°

## ORDERING EXAMPLE

①	②	③	④	⑤
BT50	-	TWC	175 -	185 - S
① Shank Size		② Name		⑤ Set
③ Min. øD		④ G.L. Length		

## ACCESSORIES for <BORING SYSTEM> TWINCUT Double-Face-Contact Shank



# INSERT for TWINCUT

TWINCUT	CODE				ISO CODE	I. C.	T	R	CARTRIDGE	SCREW	DRIVER
	STEEL	CAST IRON									
	WT25 - 079P	32901	WT25 - 079K	32911	CC**080304	7.94	3.18	0.4	CT25	BFTX0307	TRX10
	WT32 - 095P	32902	WT32 - 095K	32912	CC**090308	9.525		0.8	CT32~44	BFTX0409N	TX215
	WT62 - 127P	32903	WT62 - 127K	32913	CC**120408	12.7	4.76	CT62~125	BFTX0511N	TRX220	

NOTE : 1. Inserts are available in 10 pcs boxes.

ACCESSORIES for <BORING SYSTEM> TWINCUT · FIRSTCUT



# EXTENSION



For deeper holes.

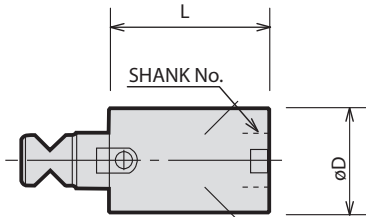

MODEL	CODE	SHANK No.	øD	L
TEX1 - 40	32610	1	24	40
TEX2 - 45	32620	2	31	45
TEX3 - 50	32630	3	42	50
TEX3 - 65	32631			65
TEX4 - 65	32640	4	54	65
TEX4 - 90	32641			90
TEX5 - 75	32650	5	64	75
TEX5 - 105	32651			105
TEX6 - 75	32660	6	82	75
TEX6 - 105	32661			105

**ORDERING EXAMPLE**

① **TEX**    ② **1**    -    ③ **40**

① Name  
② Shank No.  
③ L



# REDUCTION



For using smaller heads.

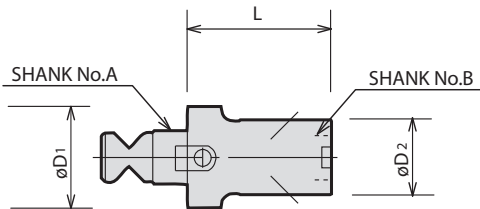

MODEL	CODE	SHANK No.A	SHANK No.B	øD1	øD2	L
RE2X1 - 60	32720	2	1	31	24	60
RE2X1 - 90	32721					90
RE3X1 - 60	32730	3	2	42	31	60
RE3X1 - 90	32731					90
RE3X2 - 60	32735	4	1	54	24	60
RE3X2 - 90	32736					90
RE4X1 - 60	32740	5	2	64	31	60
RE4X1 - 90	32741					90
RE4X2 - 60	32743	6	3	82	42	60
RE4X2 - 90	32744					90
RE4X3 - 60	32746	3	4	54	31	60
RE4X3 - 90	32747					90
RE5X2 - 60	32750	4	3	64	42	60
RE5X2 - 105	32751					105
RE5X3 - 60	32753	5	4	82	54	60
RE5X3 - 105	32754					105
RE5X4 - 60	32756	6	5	82	64	60
RE5X4 - 105	32757					105
RE6X3 - 75	32760	3	4	54	42	75
RE6X3 - 90	32761					90
RE6X4 - 75	32763	4	5	82	54	75
RE6X4 - 90	32764					90
RE6X5 - 75	32766	5	6	82	64	75

**ORDERING EXAMPLE**

① **RE**    ② **2 × 1**    -    ③ **60**

① Name  
② Shank No. A × B  
③ L